

**DESCRIPTION**

OCTO 3420 is a digital pressure gauge. Powered by 2xAA batteries, it provides up to a year of reliable readings of pressure updated twice every second in active mode, and up to 5 years in on-demand mode. For user convenience, the instrument has a backlight with auto-off feature. In addition to the current pressure reading, a multifunctional display shows minimum and maximum values since the last reset. User can trim zero and the full scale, select measurement units, decimal point position, adjust auto-off timeout.

SPECIFICATIONS

Ranges: 40 mbar to 600 bar

Basic accuracy: $\pm 0.25\%$

Sensor: silicon piezoresistive

Pressure port: G1/4"; 1/4" NPT; M20x1.5; G1/2"; other.

Media temperature: $-10 \dots +60$ °C

Ambient temperature: $0 \dots +50$ °C

Display: 4½ digits with backlight, min / max value, bargraph, units, 330° rotatable

Battery life: 1 to 5 years

Ingress protection: IP65

Features: configurable via buttons, including zero trim, auto-off; other

APPLICATIONS

General industrial applications

Process automation

Hydraulics and pneumatics

Test equipment

Liquid level monitoring

TECHNICAL SPECIFICATIONS

MEASURING RANGES

Pressure range, bar		Overpressure, bar	Burst pressure, bar	Pressure range, bar		Overpressure, bar	Burst pressure, bar
Gauge	Absolute			Gauge	Absolute		
-1...0	-	3.0	4.0	0...6.0	0...6.0	15	20
0...0.04	-	0.3	1.0	0...10	0...10	30	40
0...0.06	-	0.3	1.0	0...16	0...16	60	80
0...0.10	-	1.0	1.5	0...25	0...25	60	80
0...0.16	-	1.0	1.5	0...40	0...40	100	150
0...0.25	0...0.25	1.0	1.5	0...60	0...60	100	150
0...0.40	0...0.40	1.0	1.5	0...100	0...100	150	230
0...0.60	0...0.60	3.0	4.0	0...160	0...160	300	450
0...1.0	0...1.0	3.0	4.0	0...250	0...250	530	780
0...1.6	0...1.6	6.0	8.0	0...400	0...400	1050	1580
0...2.5	0...2.5	6.0	8.0	0...600	0...600	1050	1580
0...4.0	0...4.0	15	20				

PERFORMANCE	P > 0.4 bar	P ≤ 0.4 bar
Accuracy, % of span*	≤ ±0.25 (standard) / ± 1 digit	≤ ±0.5 (standard) ± 1 digit
Temperature effect (% of span / 10 °C)	≤ ±0.1	≤ ±0.2
Compensated range	-10...+60 °C	
Long-term stability	≤ ±0.1% of span / year	
Startup time (after switching-on)	≤ 1 s	
Measuring rate	2 measurements per second	

* Accuracy includes non-linearity, hysteresis and non-repeatability.

OPERATING CONDITIONS

Medium temperature (depends on seal)	-10...+60 °C
Ambient temperature	0...+50 °C
Storage temperature	-20...+50 °C
Vibration resistance	5 g RMS (20...2000 Hz)
Shock resistance	10 g
Pressure sensor service life	> 100×10 ⁶ cycles

* Except for devices used with aggressive media.

MECHANICAL SPECIFICATIONS

Pressure port material	stainless steel 316L (1.4404)
Seal	EPDM NBR FKM
Diaphragm	stainless steel 316L (1.4435)
Wetted parts	Diaphragm, pressure port, seal
Pressure port	M20x1.5 DIN 3852; M20x1.5 EN 837; G 1/2" DIN 3852; G 1/2" EN 837; G 1/4" DIN 3852; G 1/4" EN 837; 1/2" NPT; 1/4" NPT
Ingress protection	IP65
Dimensions, mm, max	130×80×45
Weight, max	0.3 kg

DIGITAL DISPLAY

Display type	LED digit high 15 mm, bargraph
Displayed units	bar, mbar, kPa, Pa, psi, mH ₂ O, kgf/cm ² , %
Displayed values range	-19999...+19999
Display accuracy	0.1 % of span ± 1 digit
Settling time	< 1 s (with damping disabled)

ELECTRICAL SPECIFICATIONS

Autonomous power supply voltage, V	3 V (nominal)
Battery	AA (2 batteries, 1.5 V)
Battery life (depends on mode)	1 to 5 years

DIMENSIONS (mm)

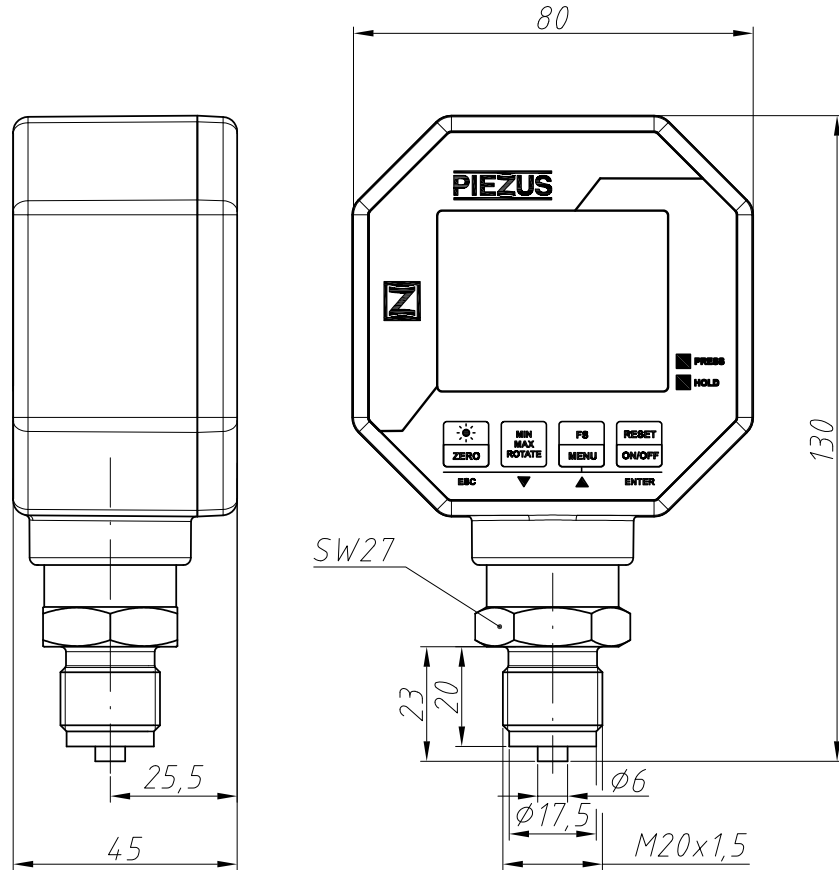

PRESSURE PORTS, DIMENSIONS (mm)

M20x1.5; G1/2" EN 837

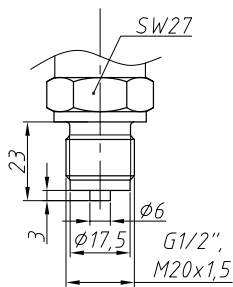

M20x1.5; G1/2" DIN 3852

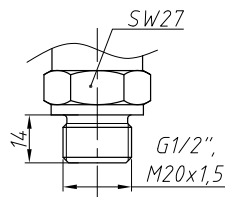

1/2" NPT

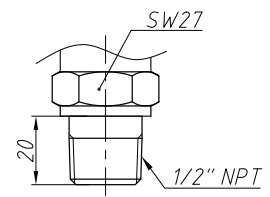

G1/4" DIN 3852

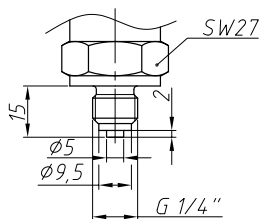

G1/4" EN 837

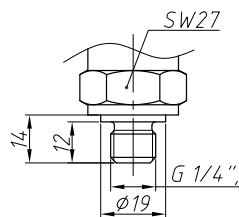

1/4" NPT

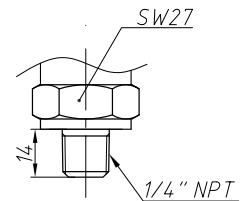

ORDERING CODE		OCTO 3420	-X	-X	-XXXX	-X	-XXX	-X	-XX
MEASUREMENT TYPE									
	Gauge	G							
	Absolute	A							
	Vacuum, LRL = -1 bar	V							
UNIT OF MEASUREMENT									
	bar	B							
	kg/cm ²	S							
	Other (specify when ordering)	X							
UPPER RANGE LIMIT (URL)									
	bar, kg/cm ²								
	0.04				0040				
	0.06				0060				
	0.10				0100				
	0.16				0160				
	0.25				0250				
	0.40				0400				
	0.60				0600				
	1.0				1000				
	1.6				1600				
	2.5				2500				
	4.0				4000				
	6.0				6000				
	10				1001				
	16				1601				
	25				2501				
	40				4001				
	60				6001				
	100				1002				
	160				1602				
	250				2502				
	400				4002				
	600				6002				
	Other				XXXX				
ACCURACY									
	0.25% (P > 0.4 bar) (standard)					C			
	0.5% (P ≤ 0.4 bar) (standard)					D			
	Other (specify when ordering)					X			
PRESSURE PORT									
	M20x1.5 DIN 3852 (standard)						200		
	M20x1.5 EN 837 (standard)						201		
	G1/2" DIN 3852 (standard)						720		
	G1/2" EN 837 (standard)						721		
	G1/4" DIN 3852 (standard)						740		
	G1/4" EN 837						741		
	1/4" NPT						840		
	1/2" NPT						820		
	Other (specify when ordering)						XXX		

ORDERING CODE (CONTINUED)

	OCTO 3420	-X	-X	-XXXX	-X	-XXX	-X	-XX
SEALS								
						FKM (standard)	F	
						NBR	N	
						EPDM	E	
						Other (specify when ordering)	X	
VERSION								
							Standard	00
							Other (specify when ordering)	XX

Example: OCTO 3420 G-B-1601-D-201-F-00

ACCESSORIES

				
DZ 10 Pressure snubber				